

Windows Server - Installation

Systemeigenschaften Windows

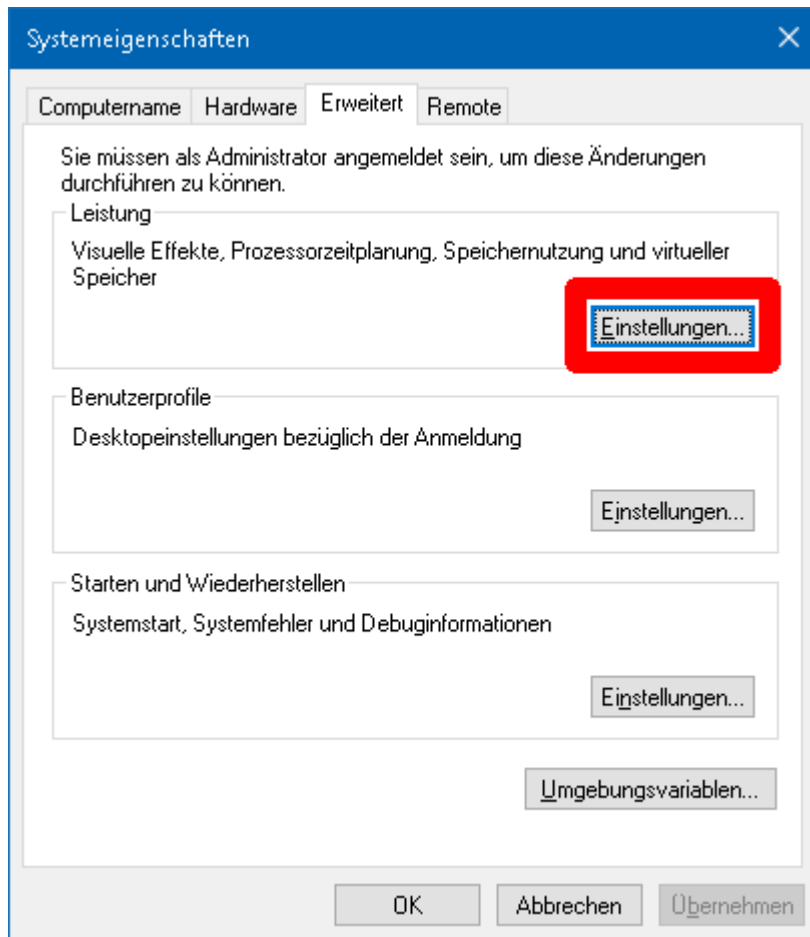

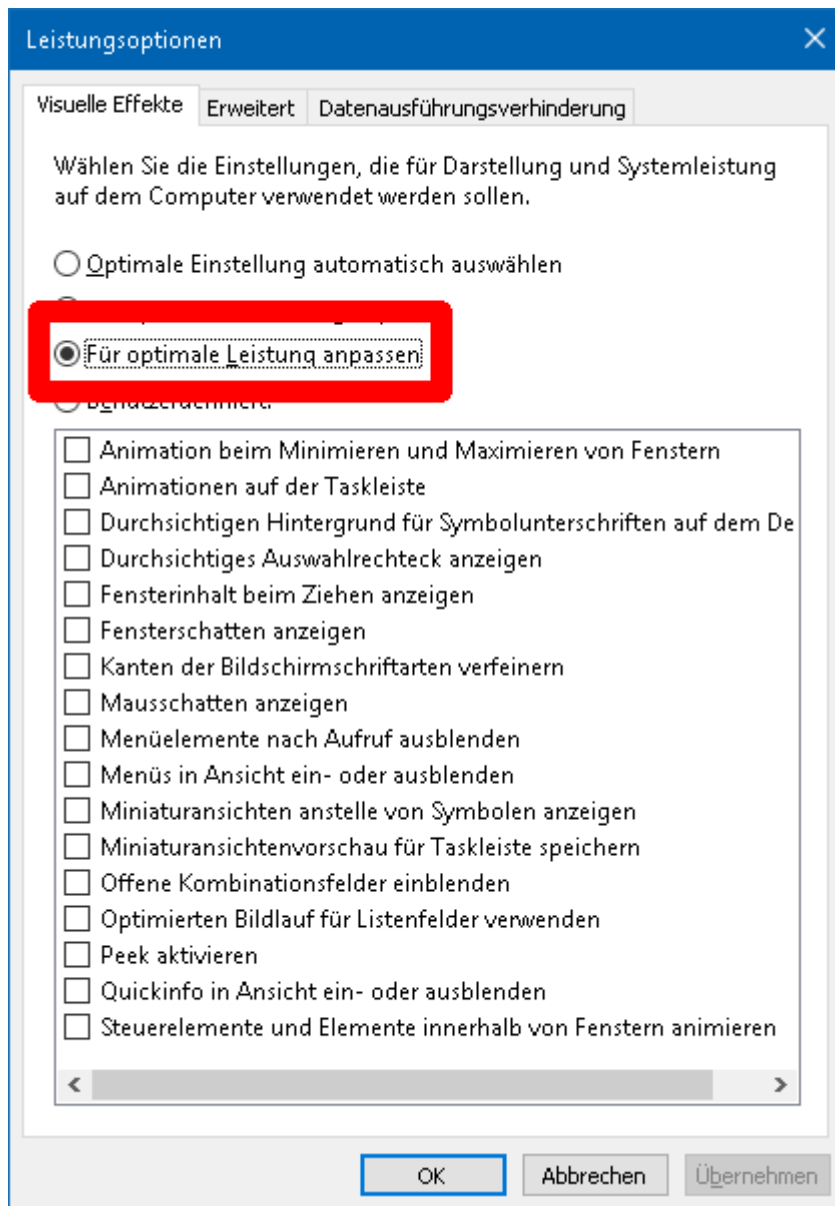

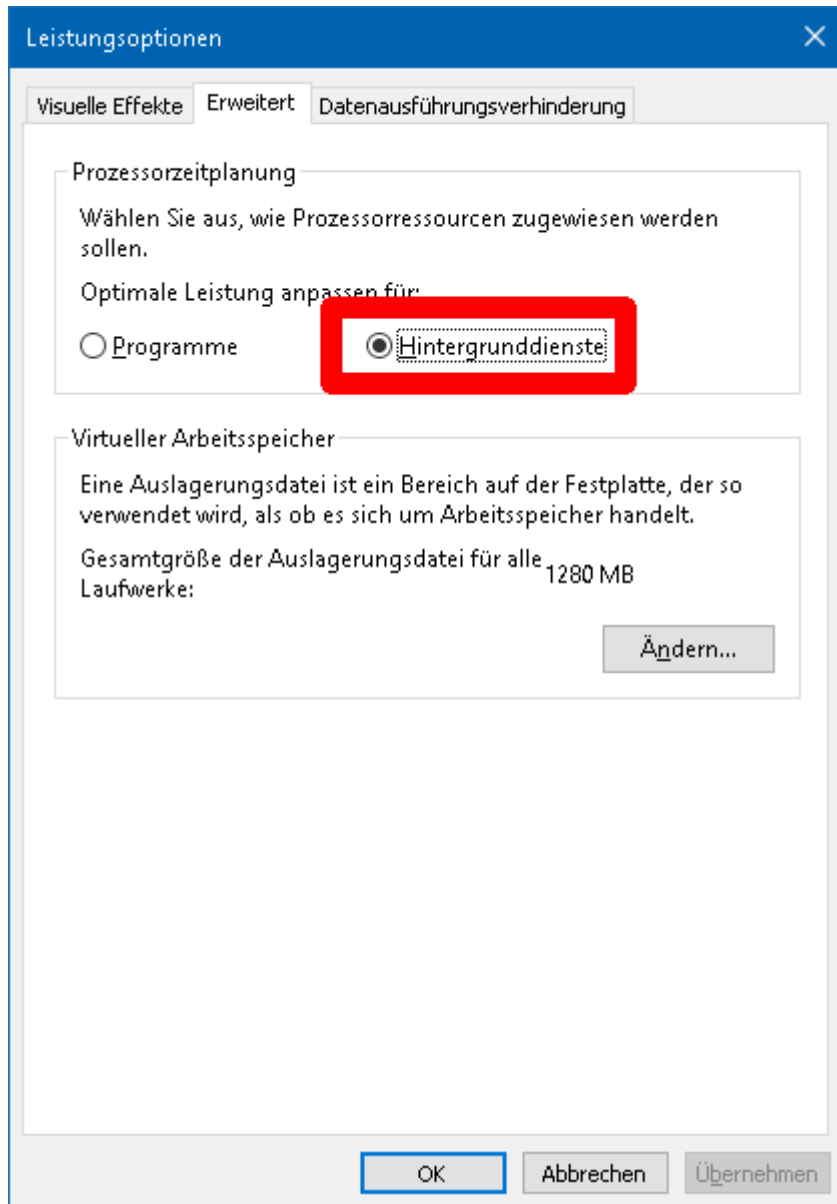

Energieoptionen

Auf Profil „Höchstleistung“ wechseln via CMD-Befehl:

```
powercfg.exe /S SCHEME_MIN
```

Netzwerkkarte - Energiesparen ausschalten:

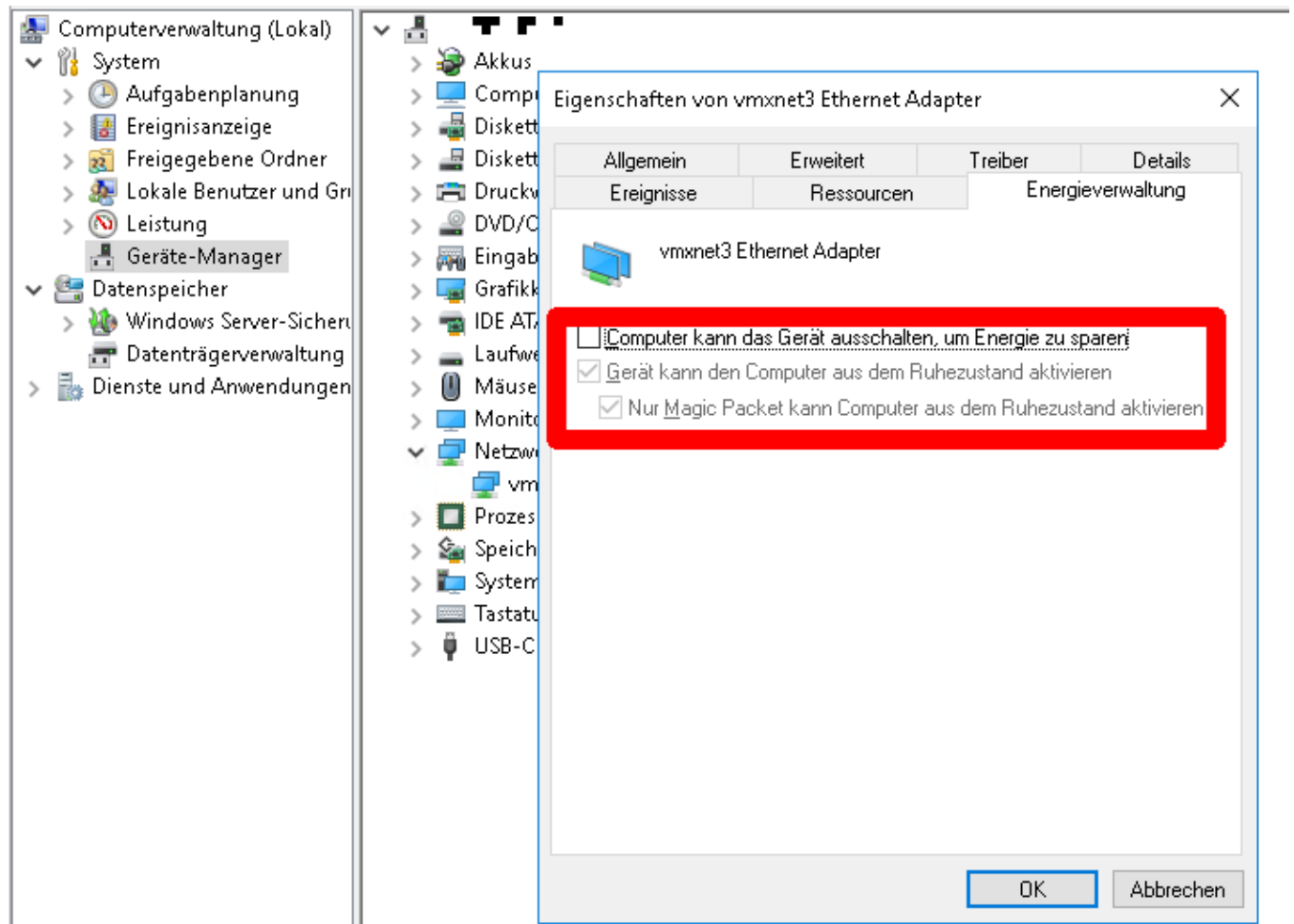

From:
<https://wiki.sebastianhetzel.net/> - **Sebastians IT-Wiki**

Permanent link:
https://wiki.sebastianhetzel.net/win_server:winserverinstall?rev=1551859549

Last update: **2019/03/06 09:05**

